

Mounting instructions

ekey dLine cable transfer 18 cm 6-core 2,5 m (Part no.: 201405)

TECHNICAL DATA

Electrical parameters: 2.5 A; 48 VDC
Cable: Li9Y11Y, 6 x 0.34 mm², RoHS compliant
IP rating: IP40/connector IP67
Temperature: from -20 °C to +75 °C

⚠ ATTENTION

Property damage in the event of incorrect mounting and wiring: The system devices are operated using electricity. They could be destroyed, e.g. by water ingress, if they are mounted and wired incorrectly.
Mount and wire the system devices correctly before connecting the power.

📖 NOTICE

These Mounting instructions are not subject to updating. We reserve the right to make technical modifications and change the product's appearance; any liability for errors and misprints is excluded.

ekey

YOUR FINGER. YOUR KEY.

ID437/839/0846: Version 1, 2025-05-15



Dimensions

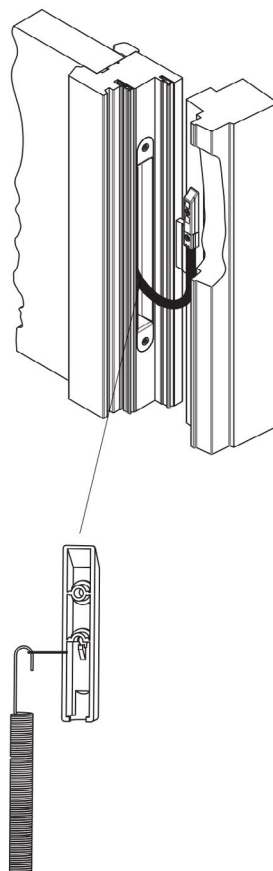
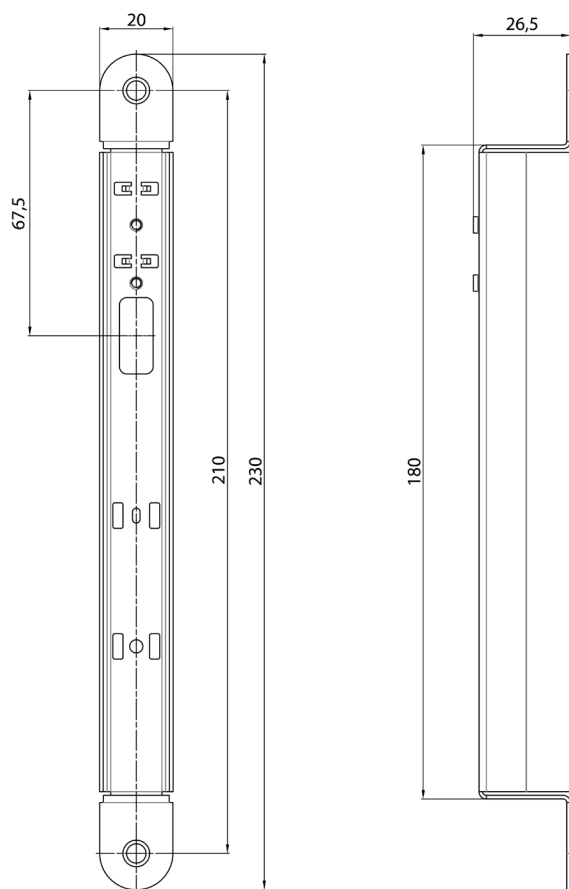

Milling dimensions for mounting into hollow profiles

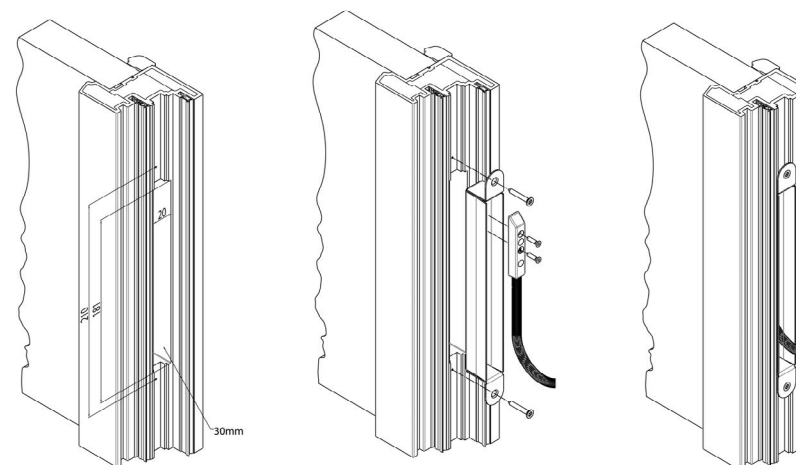

Milling dimensions for mounting into solid profiles

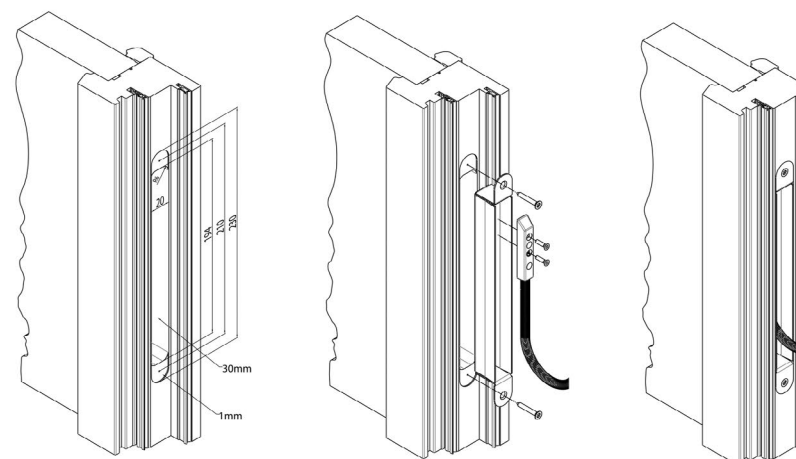

Download center

www.ekey.net/en/download-center