

Wiring diagram ekey sLine

HELLO mailbox with DoorBird door station



YOUR FINGER. YOUR KEY.

ID430/831/0/839: Version 1, 2025-03-06



850818

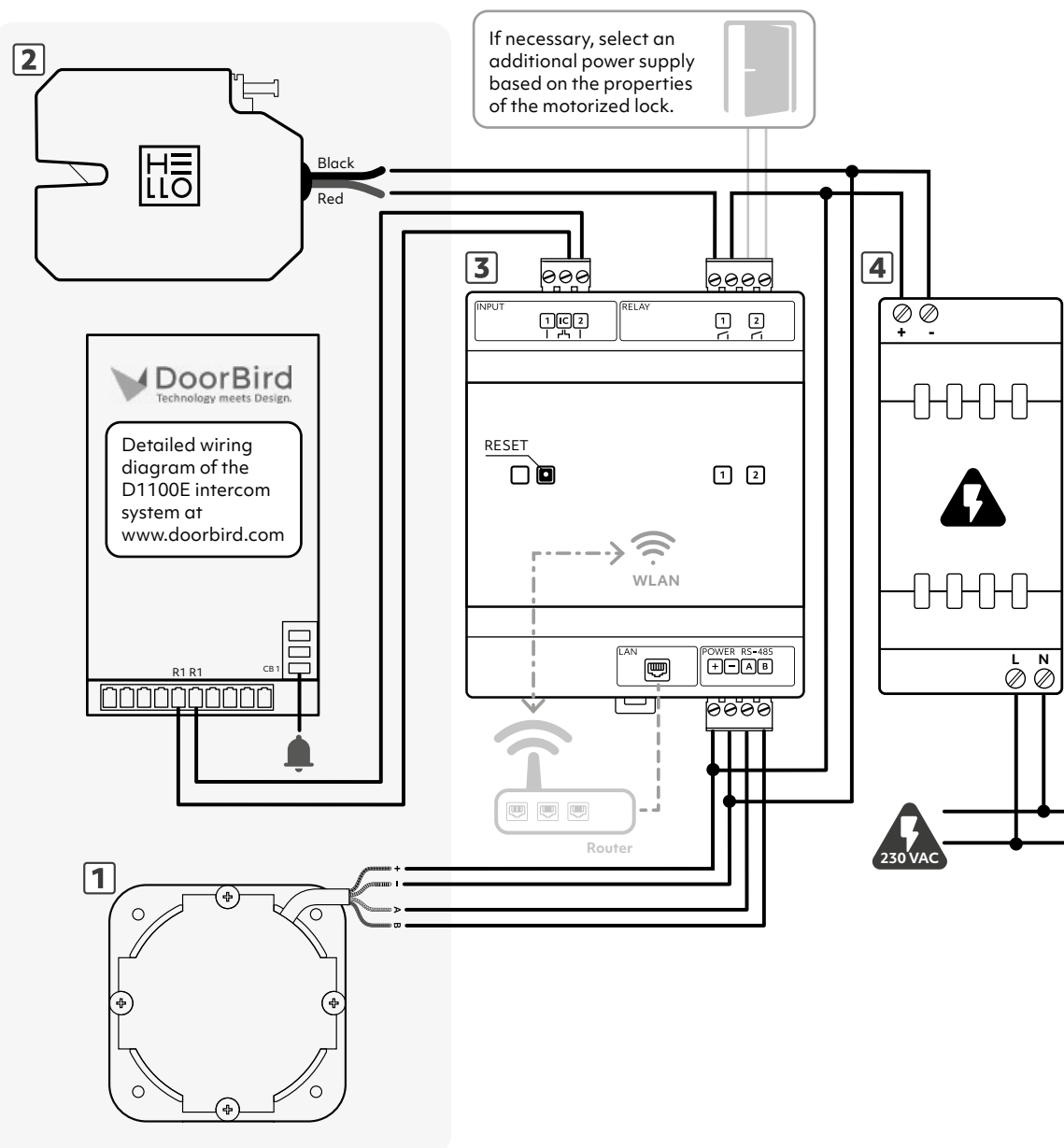

1 Connection fingerprint scanner

| | |
|-------------|-----------|
| White (+): | 12-24 VDC |
| Brown (-): | GND |
| Yellow (A): | RS-485 A |
| Green (B): | RS-485 B |

2 Connection mailbox lock

| | |
|--------|-----------------------|
| Red: | Switching impulse (+) |
| Black: | GND |

3 Connection control unit

| | |
|----------|----------------|
| + | 12-24 VDC |
| - | GND |
| A | RS-485 A |
| B | RS-485 B |
| Relay 1: | Mailbox lock |
| Relay 2: | potential-free |
| Input 1: | potential-free |
| Input 2: | potential-free |
| IC: | GND |
| LAN: | router |
| WLAN: | integrated |

4 Connection power supply

| | |
|---------|---------------|
| Input: | 230 VAC/50 Hz |
| Output: | 12 VDC |

RECOMMENDED CABLES

Power supply – control unit:

2 x 0,75 mm (H03VV-F)

Control unit – fingerprint scanner:

2 x 2 x 0,8 mm (EIB-Y St Y)

Max. cable length: 200 m

⚠ DANGER

Risk of electrocution: All ekey devices are to be operated with Safety Extra Low Voltage (SELV). Only use power supplies rated protection class 2 with safety approval according to EN 62368-1. Failure to do so will create a risk of fatal electrocution. Only certified electricians are authorized to carry out electrical installation work on mains systems.

⚠ ATTENTION

Property damage in the event of incorrect mounting and wiring: The system devices are operated using electricity. They could be destroyed if they are mounted and wired incorrectly. Mount and wire the system devices correctly before connecting the power.

📌 NOTICE

This wiring diagram is not subject to updating. We reserve the right to make technical modifications and change the product's appearance; any liability for errors and misprints is excluded.